

ZJ-KA 开通式液压快速接头 (碳钢+黄铜)

ZJ-KA STRAIGHT-THROUGH HYDRAULIC QUICK COUPLING (STEEL+BRASS)



两端开通式

Socket without valve Plug without valve



特征



ZJ-KA 系列接头具有以下特征:

任一部分均无阀的平滑开孔产生最小的压降, 并当在相同管路使用一种以上的介质时, 该种接头易于清洗。

ZJ-KA母插座及公插头采用实心棒料加工制造, 从而提供耐用的优质接头。

ZJ-KA母插座材料包括黄铜及镀锌碳钢。钢质ZJ-KA公插头的球锁沟槽表面经过渗碳淬火处理。所以能抵抗高循环速度及高压冲击锁造成的撞击剥蚀。

ZJ-KA系列为一种互换式接头, 因为它在规格和功能上可与其它制造商制造的类似连接件互换使用。

并于下列产品互换:特马 (TEMA) 3/8"3800KEW系列。

Features



ZJ-KA Series couplings:

Both plug and socket are smooth and through-hole without valve designed, which would cause minimal pressure drop. Moreover, this quick coupling is easy to be cleaned up when the same pipe required transferring different fluid.

ZJ-KA couplers and nipples are machined from solid bar stock for durability.

The ball locking grooves of ZJ-KA nipples are hardened to resist the brinelling by high cycle rates and pressure surges.

The ZJ-KA is an Interchangeable coupling because no matter dimension or function, it can interchange the similar couplings made by other manufactures.

Compatible with 3/8 TEMA 3800 KEW Series.

应用

Applications



ZJ-KA系列为无阀芯接头, 用于需要最大流量的应用。其平滑通孔设计可提供比任一其他快速接头设计的更低压降, 并可理想的用于高压水和蒸汽冲洗设备、地毯清洁设备及铸模冷却管路方面的应用。其通常用于食品加工、流体及染料转换生产线。

The ZJ-KA Series is non-valve coupling, which fit for the applications required maximum flow. Its smooth through hole design makes it to the lowest pressure drop among the quick couplings, which fit for the high-pressure water or steam washing equipment, carpet cleaning equipment and die casting cooling pipe. It is usually in the food processing, fluid and dye transfer production line.

规格(英寸) Body Size(in)	规格代号 Code	额定压力 (MPa) / Rated Pressure(MPa)			额定流量 (L/min) Rated Flow(L/min)	温度范围 (丁腈橡胶) / 温度范围 (氟橡胶) Temperature Range(NBR) / Temperature Range(FKM)	
		碳钢 Steel	不锈钢 Stainless Steel	黄铜 Brass			
3/8	03	13.8			45.5	-20°C~+100°C	-20°C~+180°C

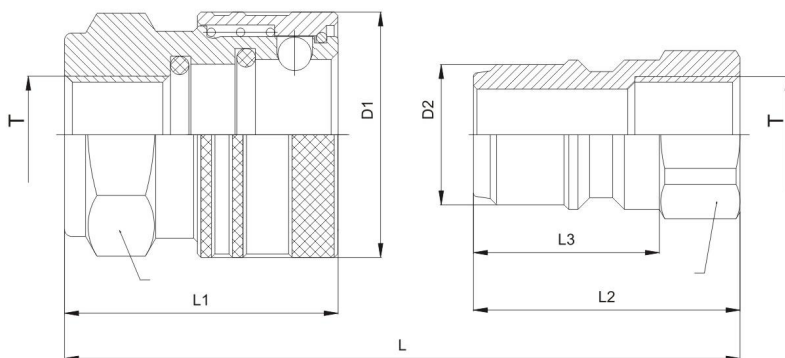

性能 (Performance)
测试流体: 油-200SUS (Test Fluid:oil-200SUS)

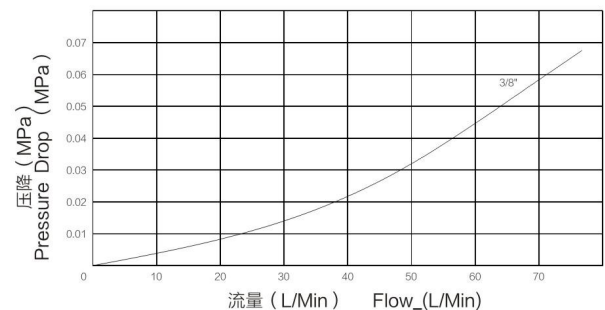

PART NO.	ISO	L	L1	L2	L3	D1	D2	CH1	CH2	T		
ZJ-KA-03-SP	DN10	53	39	38	26.5	35	20	30	22	ZG3/8	G3/8	NPT3/8